

Instruction for the 1cc-Filesharetool

Login:

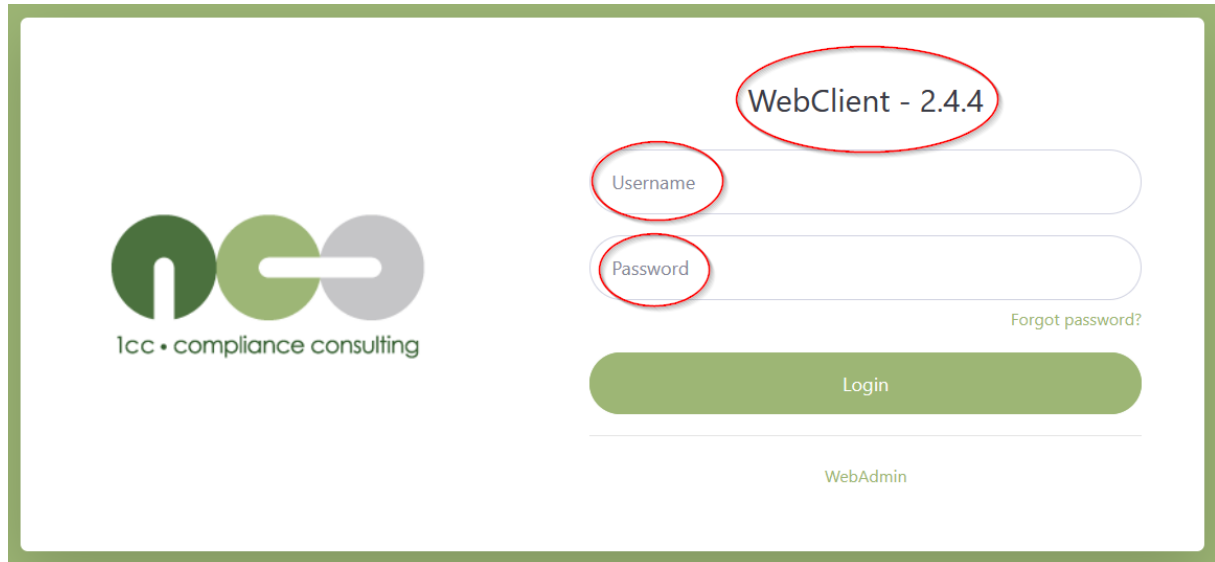

The login interface for WebClient 2.4.4. On the left is the logo for '1cc • compliance consulting'. On the right, the version 'WebClient - 2.4.4' is displayed. Below it are two input fields: 'Username' and 'Password', both highlighted with red circles. To the right of the password field is a link 'Forgot password?'. Below the input fields is a green 'Login' button. At the bottom right, the text 'WebAdmin' is visible.

Overview:

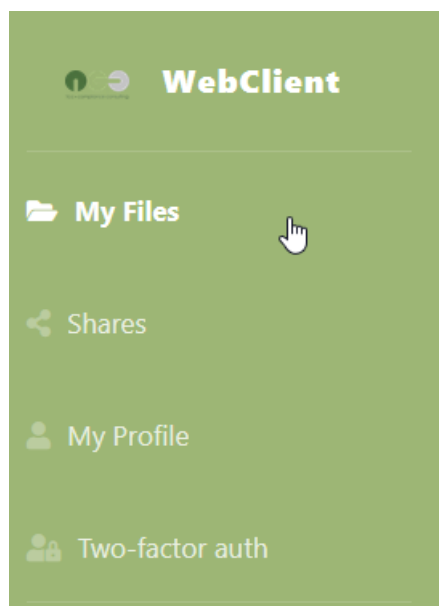

Under **“My files”** you can browse in your directory.

“Shares” is not needed for the intended use.

Under **“My Profile”** you can set your Email-Address if not configured.

Under **“Two-factor auth”** you can set up the 2FA.

My Files:

Home

Show

10

entries

1

2

3

4

Search:

	Name	Size	Last modified
4	<input checked="" type="checkbox"/> Auditee_Uploads		2023-04-12 11:11
	<input type="checkbox"/> CAP		2023-04-12 11:11
	<input type="checkbox"/> Report		2023-03-21 16:35

Showing 1 to 3 of 3 entries

1 item selected

Previous

1

Next

- 1: Upload files in the current directory
- 2: Download selected files/directory (4)
- 3: refresh page
- 4: select directory or file

My Profile:

My profile - Test

Email

Description

Email address needed for a password reset.

Two-factor-authentication:

If the two-factor-authentication is not enforced, you can ignore this part of the instruction.

Setup:

First navigate to the “Two-factor auth” tab after your first login.

TOTP (Authenticator app)

Status: "Disabled"

SSH protocol (SFTP/SCP/SSH commands) will ask for the passcode if the client uses keyboard interactive authentication.

HTTP protocol means Web UI and REST APIs. Web UI will ask for the passcode using a specific page. For REST API you have to add the passcode using an HTTP header.

FTP has no standard way to support two factor authentication, if you enable the FTP support, you have to add the TOTP passcode after the password. For example if your password is "password" and your one time passcode is "123456" you have to use "password123456" as password.

WebDAV is not supported since each single request must be authenticated and a passcode cannot be reused.

Require two-factor auth for **1** HTTP, SSH

Configuration **2** Default

3 Generate new secret

1: Select HTTP and SSH as protocols

2: Select “default” for the configuration

3: after selecting the first two steps, click the button “generate new secret”. This will generate a QR Code

Require two-factor auth for HTTP, SSH

Configuration Default

Your new TOTP secret is: YLZOR5TKORBFA67ECVDSZJAFI64HACT

For quick setup, scan this QR code with your TOTP app:

 **4**

After you configured your app, enter a test code below to ensure everything works correctly. Recovery codes are automatically generated if missing or most of them have already been used

Authentication code **5** **6** Verify and save

4: After the QR code has been generated, it must be scanned in the TOTP app (MS or Google Authenticator). The app will now generate a new password every 30 seconds.

Example for the Microsoft Authenticator:

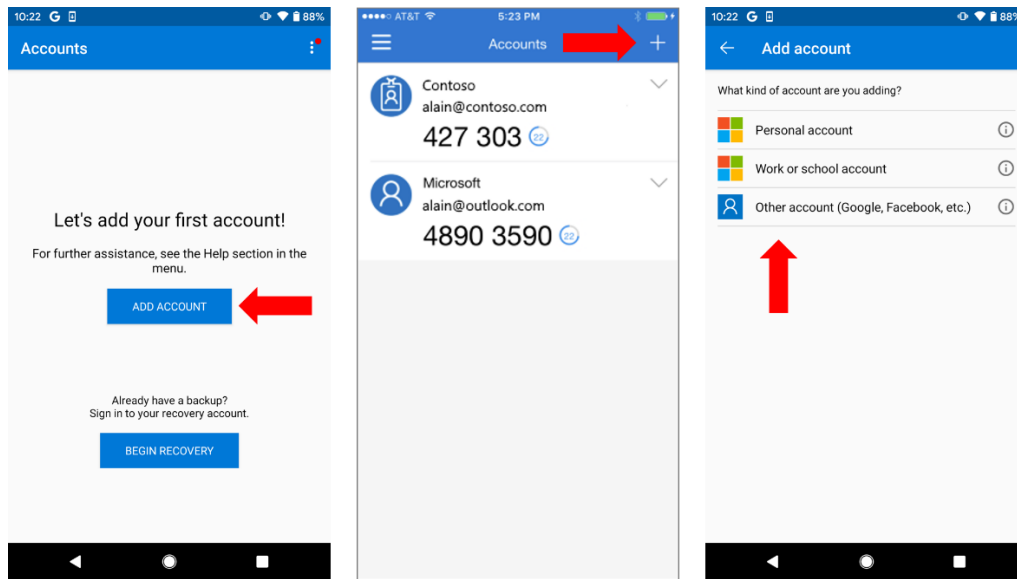

5: The code must now be entered within the 30 seconds time limit to complete the setup

6: Immediately after entering the code, click "Verify and save" to complete the set up.

The image shows a web client interface for 'WebClient - 2.4.4'. On the left is the logo for '1cc • compliance consulting'. On the right, there is a form with an 'Authentication code' field containing a red box with the number '7'. Below this is a large green 'Verify' button. Under the button, there is a message: 'Open the two-factor authentication app on your device to view your authentication code and verify your identity.' Below this message is a link 'Having problems?' and a text input field labeled 'Enter a two-factor recovery code'.

7: Now every time you log in, after entering the username & password, this window will appear where you must enter the code of the authenticator-app.